



ALANKOMAAT

MAR-C1013

HEIDI JORONEN

PINJA RANTONEN

JOHANNA SALMELA





**ILMASTON-
MUUTOS**

VESI

RATKAISUT

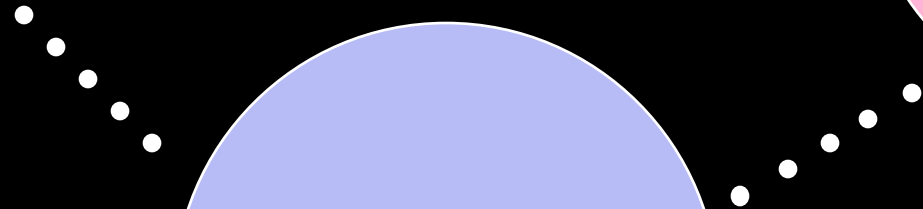



ALANKOMAAT & MAISEMA

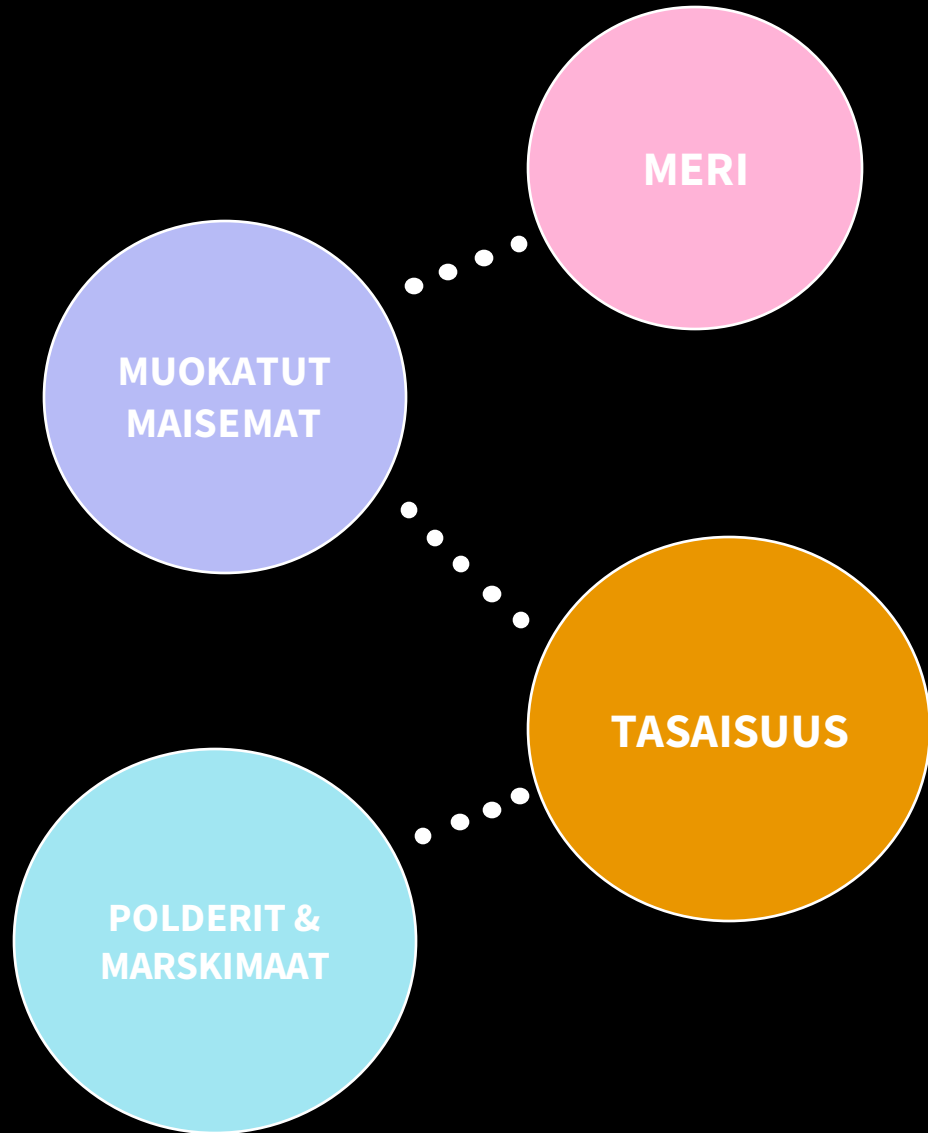



TULVAPADOT





POLDERI

MARSKIMAA

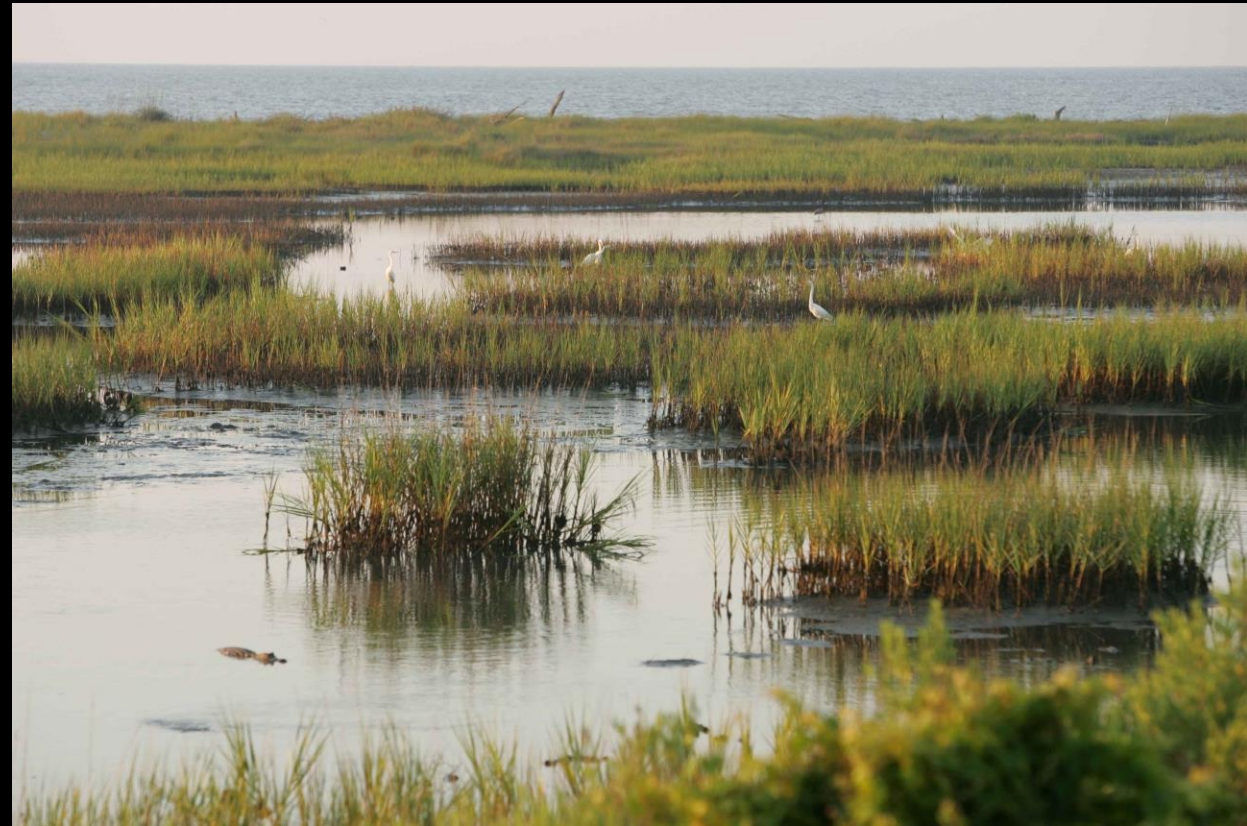

KOHTI ALANKOMAALAISTA MAISEMA-ARKKITEHTUURIA







<https://whc.unesco.org/en/list/1349/>



<https://www.holland.com/global/tourism/destinations/provinces/north-holland/unesco-world-heritage-sites-beemster-and-de-schermer-en.htm>





https://www.gardenvisit.com/gardens/palais_het_loo





<https://www.cntraveler.com/gallery/overview-benjamin-grant-satellite-images-of-earth>

Google Maps: Westland



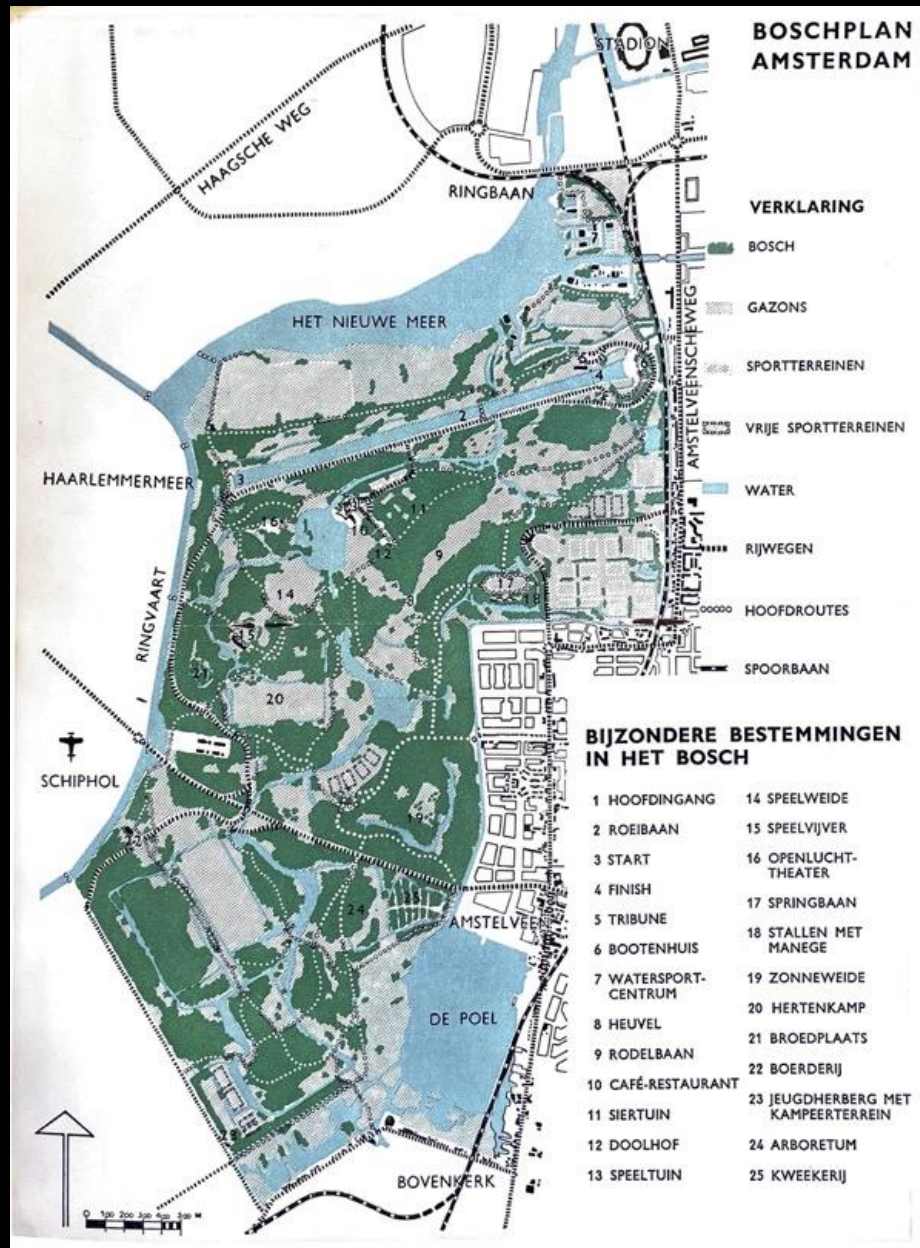

https://commons.wikimedia.org/wiki/File:Afsluitdijk_oost.jpg



Dutch Land Reclamation Efforts 1300-2000

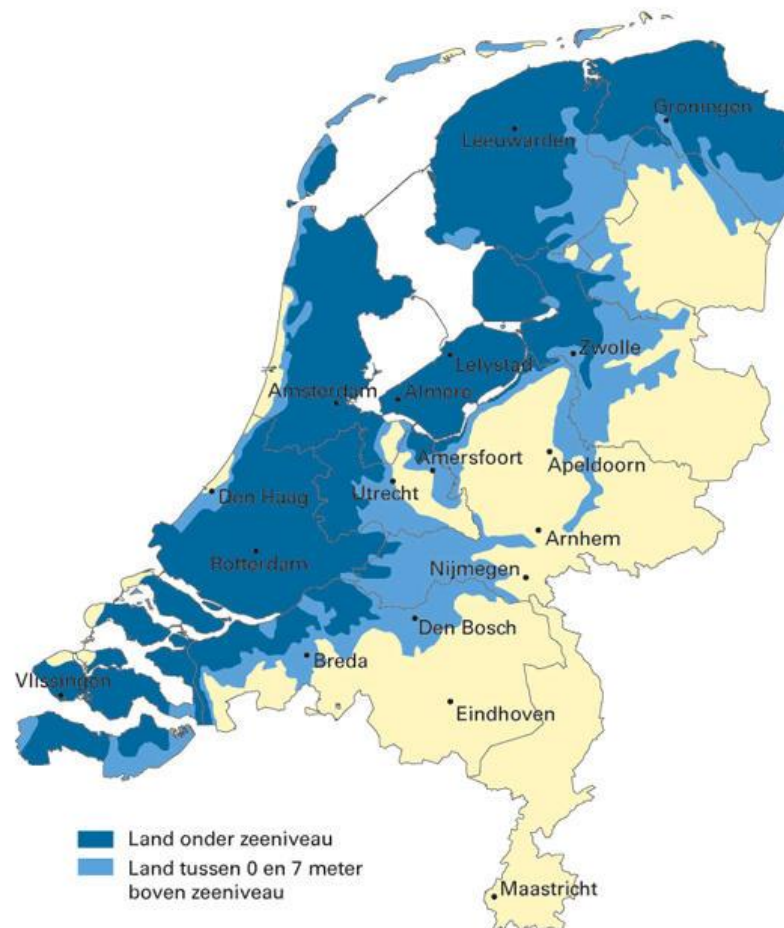
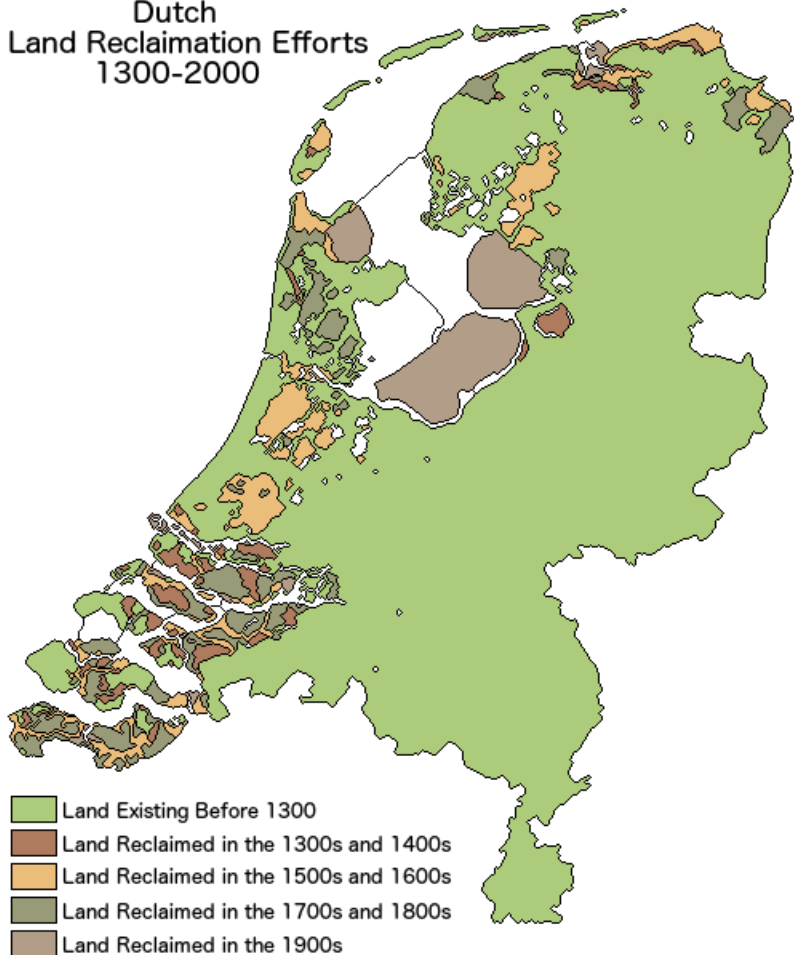

Kaart:
Hans van der Maarel
Red Geographics





https://en.wikipedia.org/wiki/Christmas_Flood_of_1717#/media/File:Christmas_flood_1717.jpg



<https://www.rijkswaterstaat.nl/en/water/water-safety/the-flood-of-1953>





<https://www.rijkswaterstaat.nl/en/water/water-safety/delta-works>



https://images.frieschdagblad.nl/frd/images/l79bbt-De-ecokathedraal-bij-Mildam./alternates/LANDSCAPE_1280/De%20ecokathedraal%20bij%20Mildam.



● MAISEMA-ARKKITEHTUURIN KOULUTUS

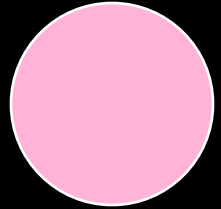

WAGENINGEN UNIVERSITY (WUR)

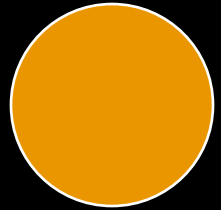

AMSTERDAM ACADEMY OF ARCHITECTURE



DELFT UNIVERSITY OF TECHNOLOGY





<https://j8a3m7f3.rocketcdn.me/wp-content/uploads/2021/01/Client-Case-Wageningen-University.jpg>





https://upload.wikimedia.org/wikipedia/commons/8/8f/Amsterdam_-_Stadsturfpakhuizen_Nieuwe_Amstelstraat_6.JPG





<https://upload.wikimedia.org/wikipedia/commons/1/1e/TU-Delft-Bibl-2.jpg>



EMMELIE VAN OMMEN – QUALITY LANDSCAPES IMPACTED BY UNCERTAIN SEA LEVEL RISE

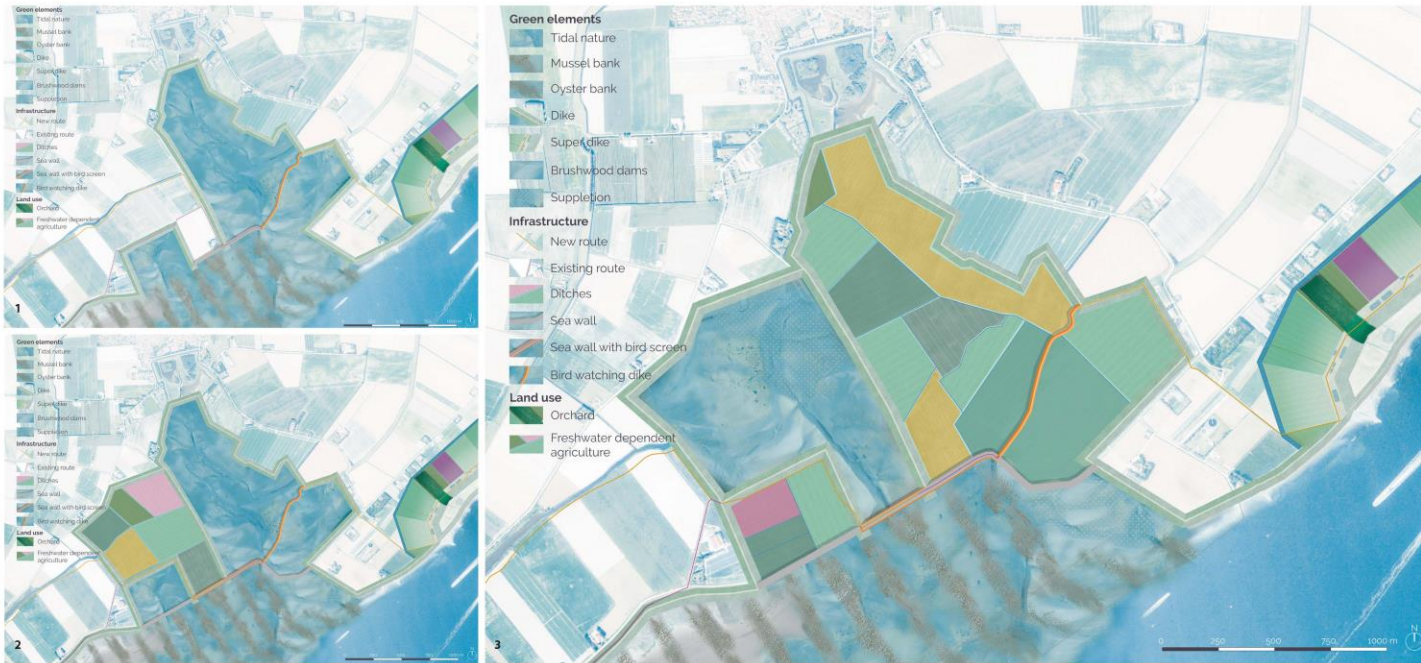

The final detailed design in three steps. A switching landscape to let problematic land silt up with SLR for nature and agriculture on the long term, with an open Oosterschelde barrier.



- Merenpinnan nousu
- Maiseman laadun säilyttäminen
- Veden turvallisuus
- Veden saatavuuden lisääminen
- Suolaisuus





MARTIJN BRINKMAN – LOWERING THE PEAKS

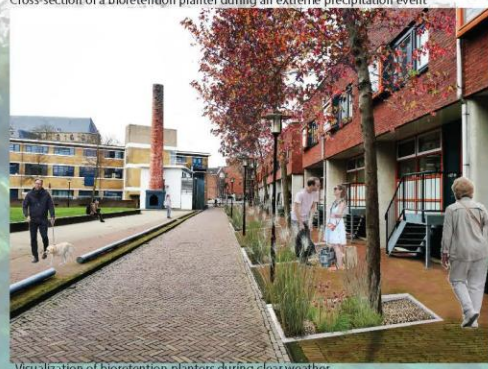
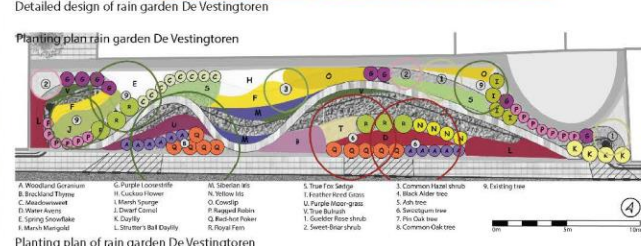
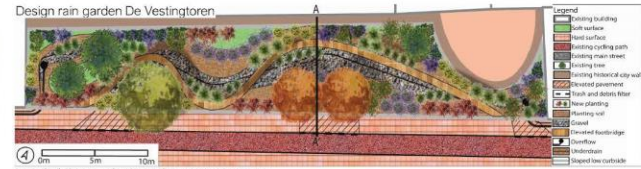

-  Rajut vesisateet
-  Pluviaali tulviminen
-  Viemäreiden kantokyky
-  Urbaani maisema
-  Kaupunkiakupunktio



KATARZYNA KLANCKO – URBAN BREATHABILITY



- Ilman saastuminen
- Pienhiukkasten konsentraatio
- Saasteiden aiheuttajien eliminointi?
- Kaupunkien ilmastointi-järjestelmät
- Fytoremediaatio





NYKYAJAN MAISEMA-ARKKITEHTUURIN PROJEKTEJA





ADAPTIVE DIKE DESIGN | H+N+S Landschapsarchitecten | 2015-2016

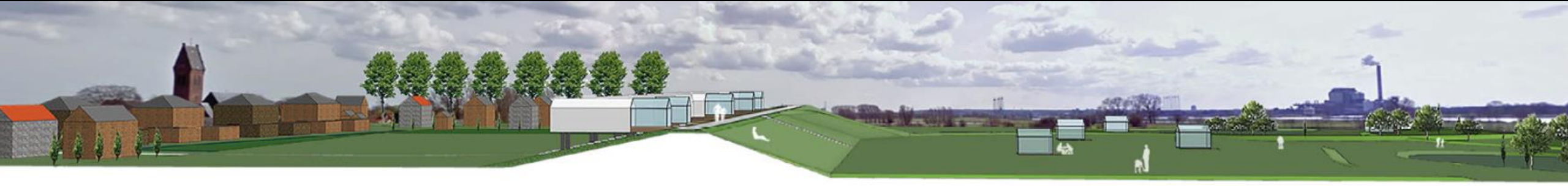

<http://www.hnsland.nl/en/projects/adaptive-dikes>

SYKLINEN
ASUMINEN

PATO
OSAKSI
MAISEMAA

PAIKALLINEN
TUKI

PATO REAGOI
YMPÄRISTÖÖN



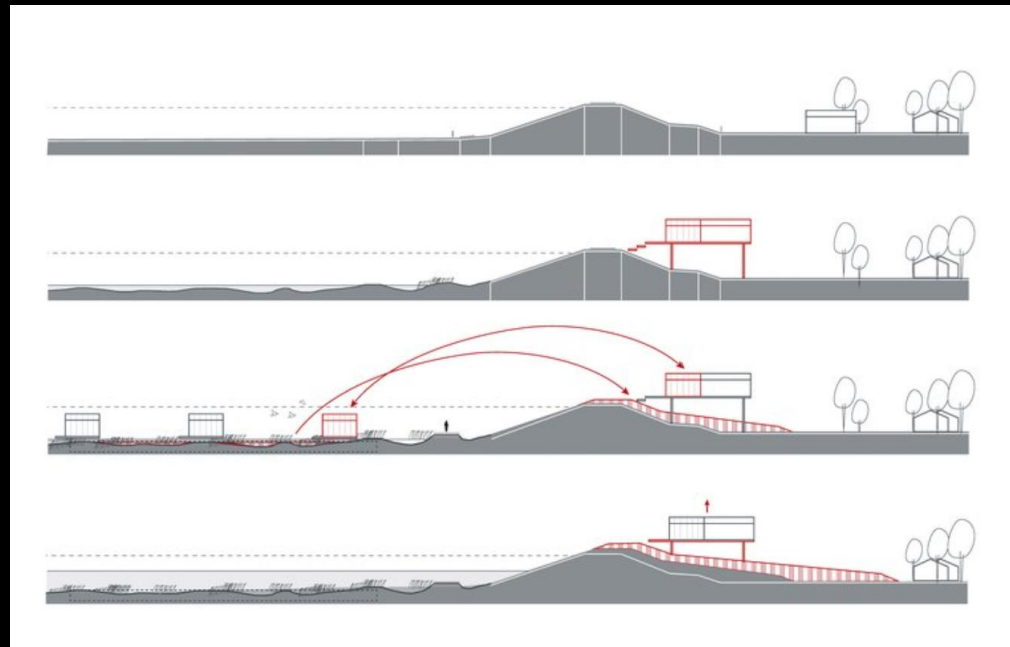
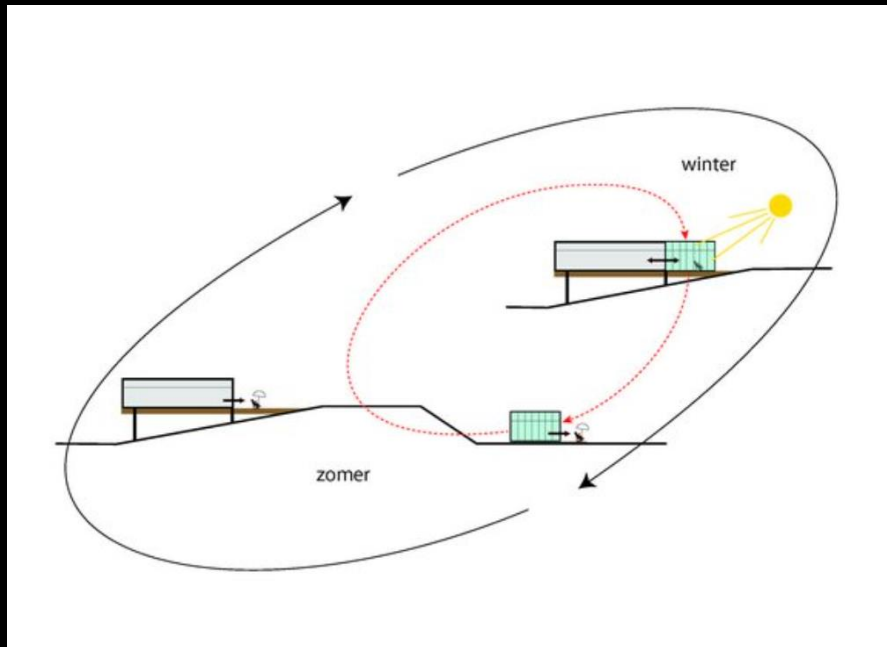



MERWEDE DISTRICT | LOLA | 2023 ALKU

BIODIVERSITEETTI

**AUTOVAPAA
ALUE**

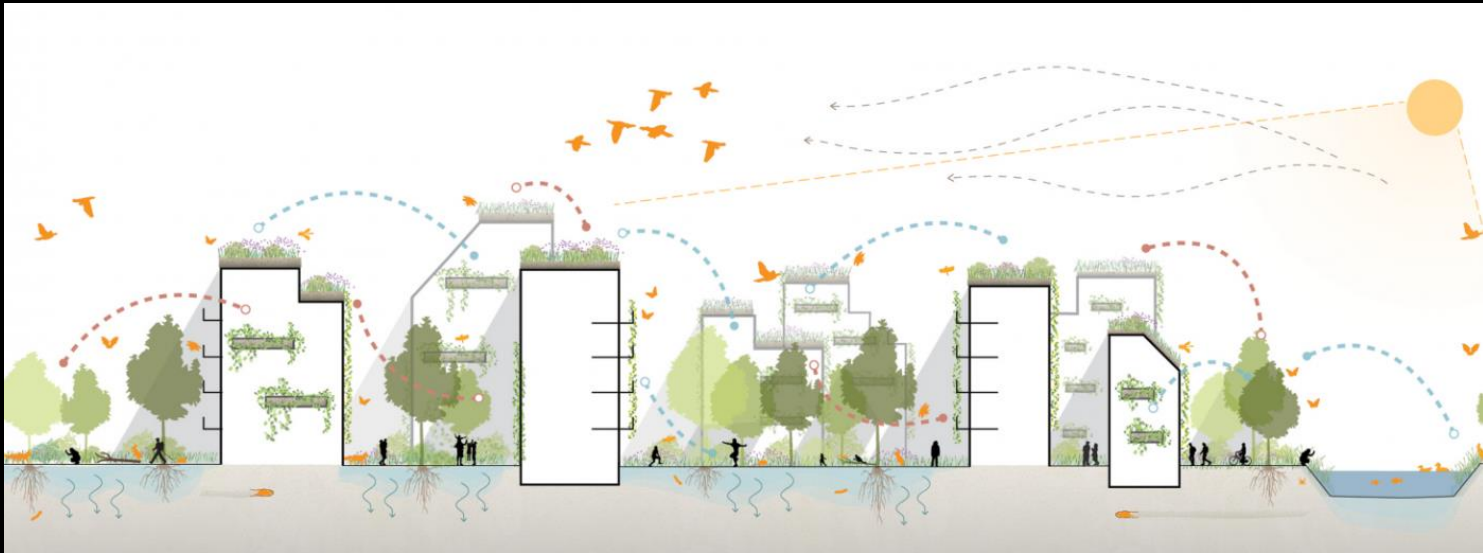

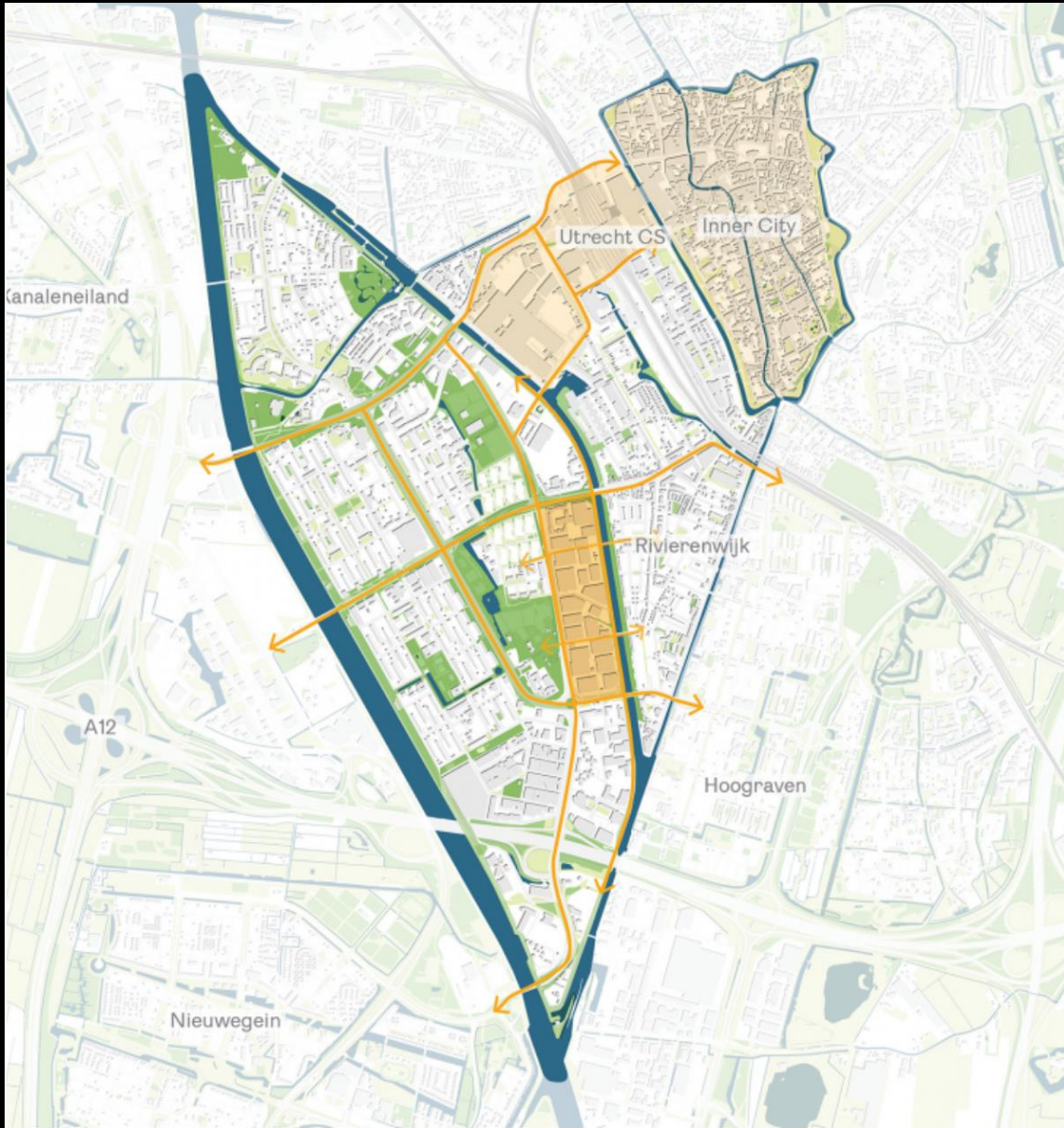



ROOM FOR THE RIVER NIJMEGEN | H+N+S Landschapsarchitecten | 2013–2016

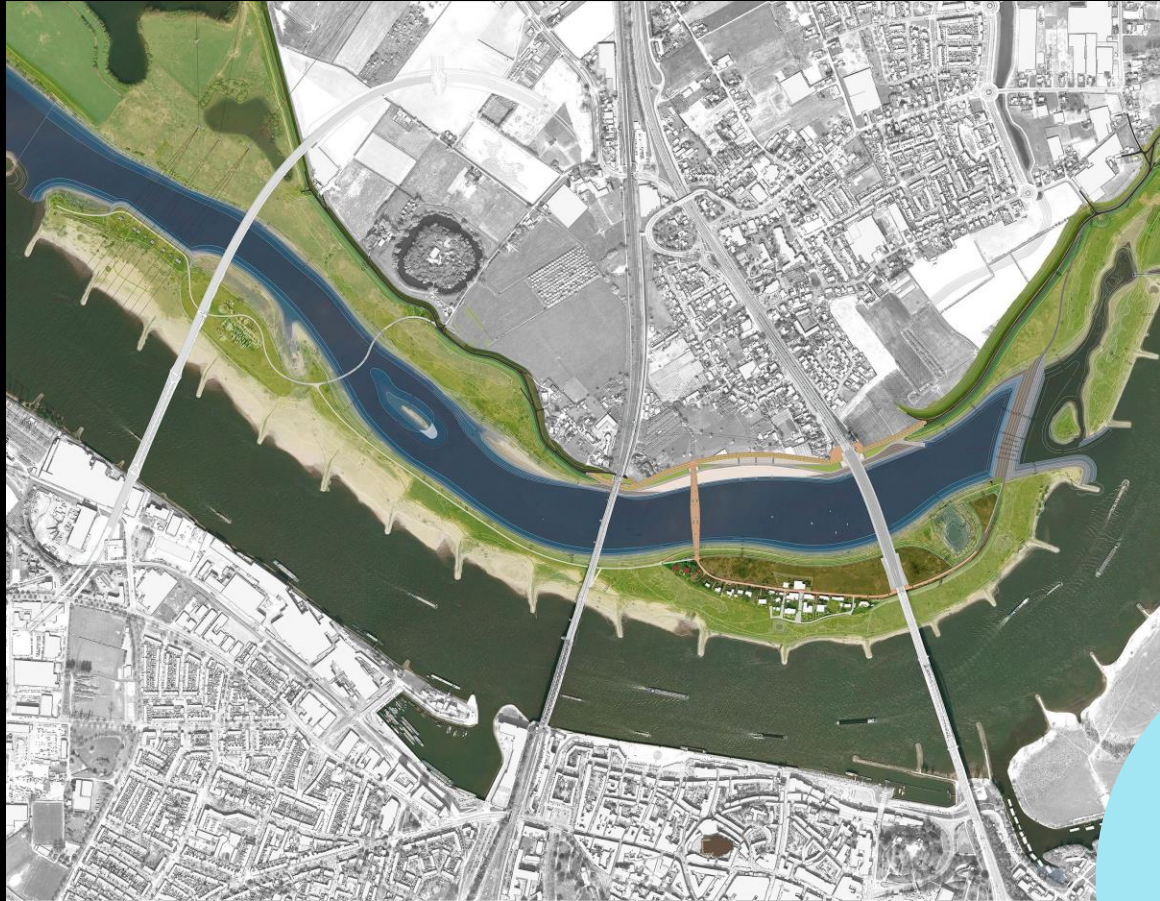

TULVARISKIEN
VÄHENTÄMINEN

TILAA
VEDELLE

<http://www.hnsland.nl/en/projects/room-river-nijmegen>





WATERPLAN ANTWERP | De Urbanisten | 2018–2019



KORJAUS-
LIIKE

KAUPUNGIN
KOKOINEN
SKAALA

<https://www.urbanisten.nl/work/waterplan>

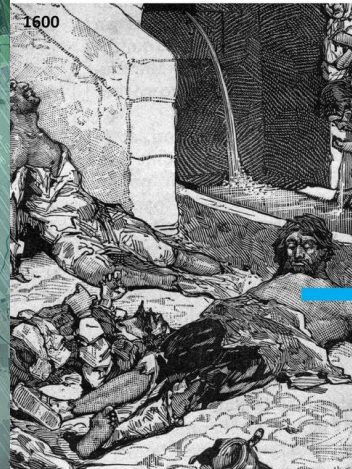
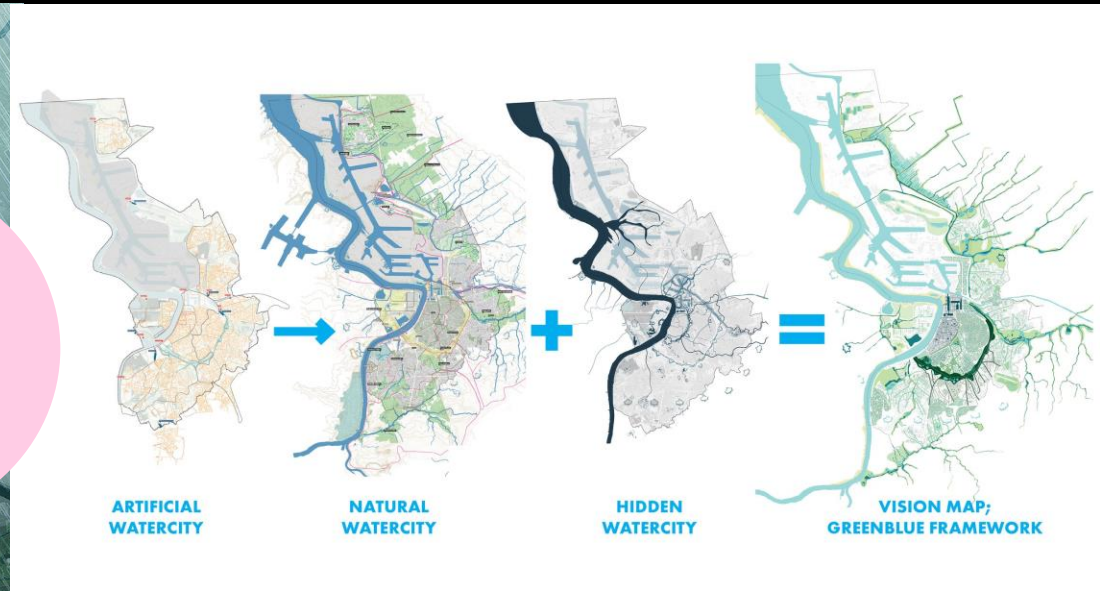

1600
bad sanitation and hygiene caused the outbreak of a cholera epidemic



1928
Because of this the municipality decided on covering of the canals in the historical



2019
Today the "Ruien" are still covered and invisible in the historical city centre



THE NEW HONDSBOSSCHE DUNES | West 8 | 2016

DYNAAMINEN
JA
MUUTTUVA



<https://architizer.com/projects/the-new-hondsbosche-dunes/>

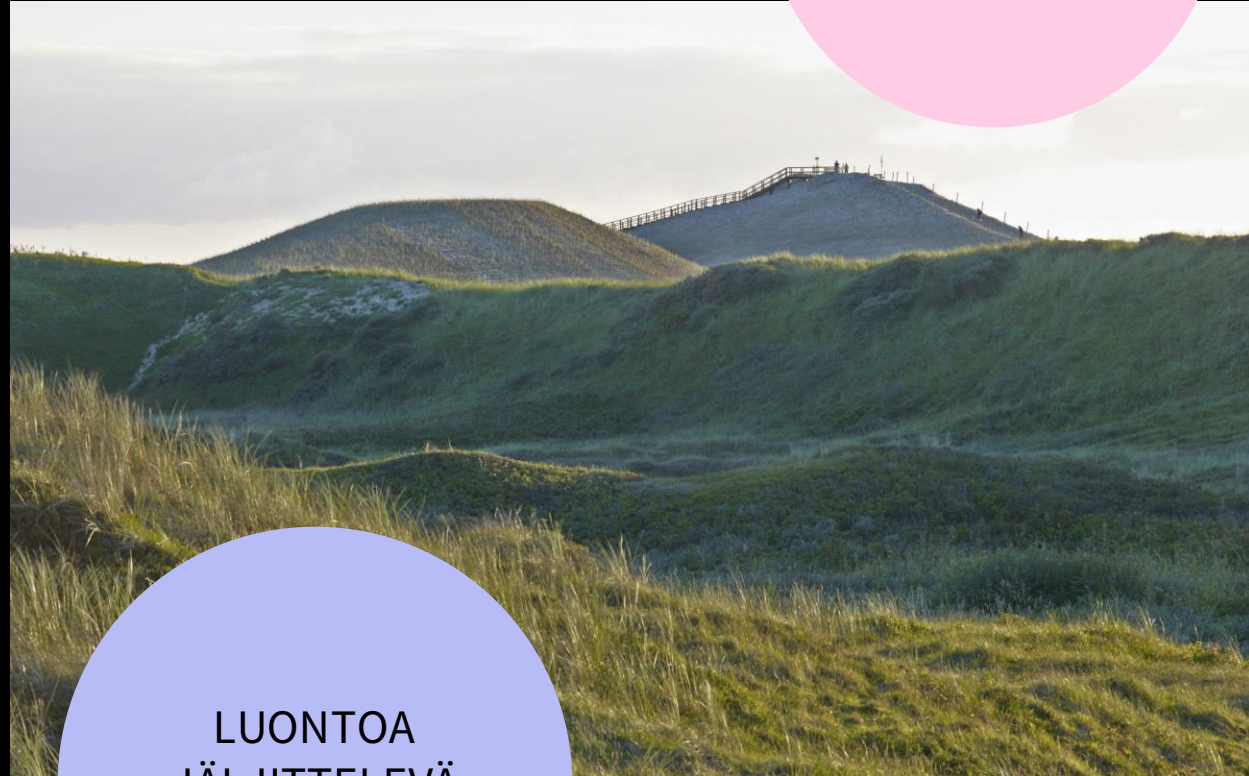

LUONTOA
JÄLJITTELEVÄ
RAKENTAMINEN





ZALIGEBRUG | NEXT Architects | 2016

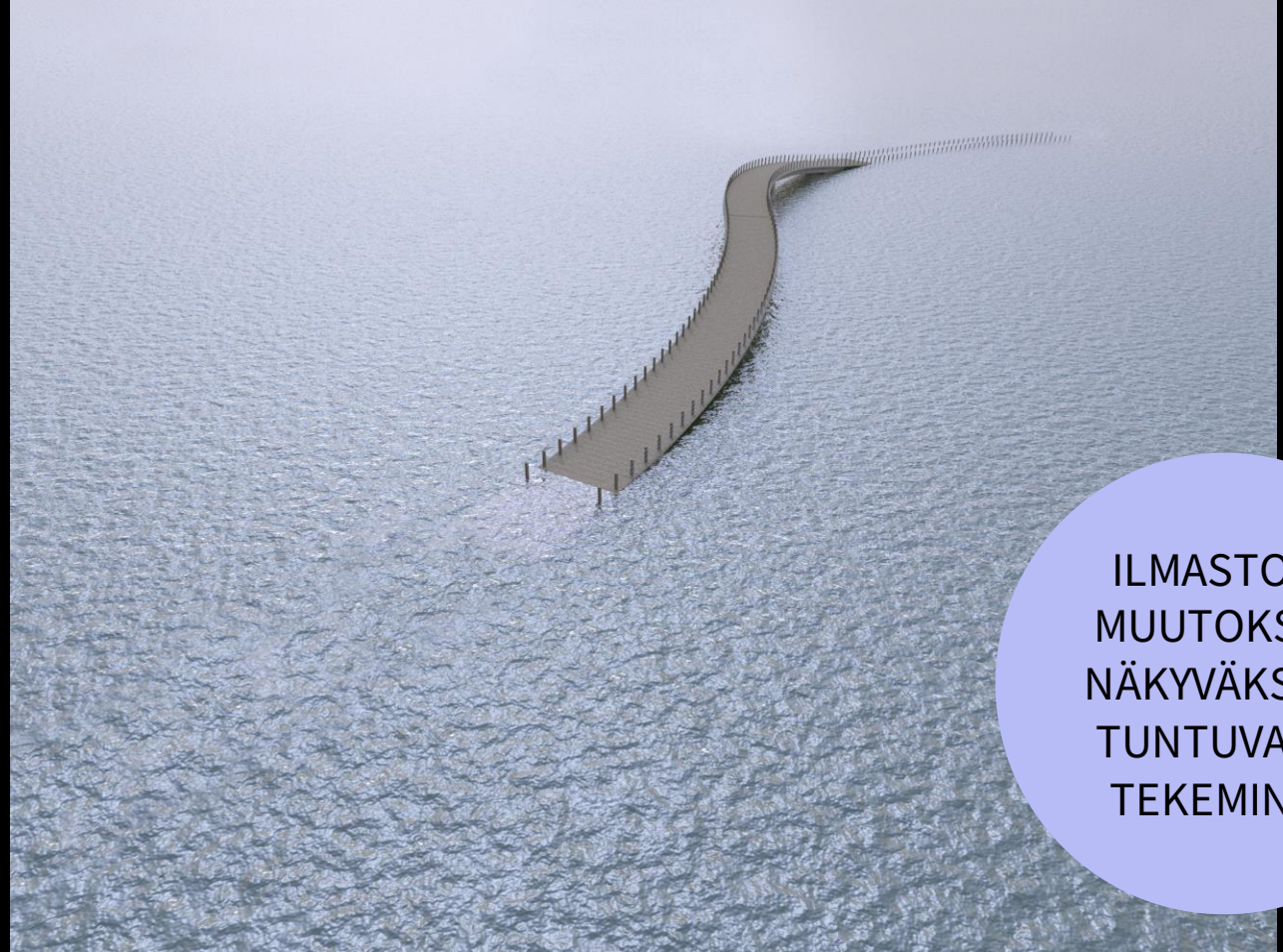

ILMASTON-
MUUTOKSEN
NÄKYVÄKSI JA
TUNTUVAKSI
TEKEMINEN

<https://www.dezeen.com/2018/01/16/zalige-bridge-next-architects-hns-landscape-architects-stepping-stones-nijmegen-netherlands/>

<https://www.nextarchitects.com/zalige-bridge/>





DELTAWERK // | RAAAF | 2018

KEHOLLINEN
KOKEMUS



KYSEEN-
ALAISTAMINEN



<https://www.dezeen.com/2018/10/04/raaaf-atelier-de-lyon-delta-werk-monument-dutch-delta-works/>





MAISEMA-ARKKITEHTUURIN TULEVAISUUS ALANKOMAISSA?





VEDEN ARMOILLA?



MUUTOKSEN HYVÄKSYMINEEN?



LÄHTEET

KIRJALLISUUS

Deunk, G. *20th Century Garden and Landscape Architecture in the Netherlands*. 2002. NAI Publishers.

Ibelings, H. (toim.). *The Artificial Landscape. Contemporary architecture, urbanism, and landscape architecture in the Netherlands*. 2000. NAI Publishers.

Rutte, R. & Abrahamse, J.E. (toim.) *Atlas of the Dutch Urban Landscape. A Millennium of Spatial Development*. 2016. THOTH Publishers.

VERKKOLÄHTEET

de Jonge, J. *Landscape Architecture between Politics and Science. An integrative perspective on landscape planning and design in the network society*. 2009. Modern Bennekom. <https://core.ac.uk/download/pdf/29254506.pdf>.

RAAAF. *Indestructible Holland. A tribute to a culture of delta Experiments*. 2017. <https://www.raaaf.nl/downloads/Indestructible%20Holland%2C%20A%20tribute%20to%20a%20culture%20of%20delta%20experiments%2C%20RAAAF.pdf>

<https://www.rijkswaterstaat.nl/en/water/water-safety/delta-works>

<https://www.dutchooloflandscapearchitecture.nl/en/studying-landscape-architecture-in-the-netherlands/>

<https://www.wur.nl/nl/Onderwijs-Opleidingen/Bachelor/BSc-opleidingen/BSc-Landschapsarchitectuur-en-Ruimtelijke-Planning.htm>

<https://www.wur.nl/en/education-programmes/master/msc-programmes/msc-landscape-architecture-and-planning.htm>

<https://www.bouwkunst.ahk.nl/en/study-programmes/master-in-landscape-architecture/>

<https://www.tudelft.nl/en/education/programmes/masters/architecture-urbanism-and-building-sciences/msc-architecture-urbanism-and-building-sciences/master-tracks/landscape-architecture/programme>

KUVALÄHTEET, JOITA EI OLE MAINITTU KUVIENYHTEYDESSÄ

http://www.hnsland.nl/media/filer_public_thumbnails/filer_public/f4/2a/f42a516f-c9ab-4300-8935-3348016b0aca/dijkaanweteringland_oudablas_foto.png__1440x810_q85_crop_subsampling-2.jpg (tulvapatot)

<https://pixnio.com/free-images/nature-landscapes/wetlands-and-swamps/marshland-landscape-scenic.jpg> (polderikuva)

<https://s.hdnu.com/photos/31/01/33/6559430/4/1200x0.jpg> (marskimaakuva)

https://www.west8.com/wp-content/uploads/2019/05/10785_large.jpg (siltakuva)

http://www.hnsland.nl/media/filer_public_thumbnails/filer_public/25/a9/25a979f9-9f65-48dc-9b4e-bb543ade8cd9/34a_dynamische_kust_de_zandmotor_beeldbankrws.jpg__1440x0_q85_crop_subsampling-2.jpg (rannikkokuva)

