

# The Future of Hanasaari Power Plant

Situation Overview 13.12.2023  
Päivi Hietanen, Project Director

Helsinki





- Architecturally and cultural historically significant
- Represents the latest building technology of its time, strong connection to the history of urban development
- Building historic assessment 2015 - the power plant is not protected

Architect  
Timo  
Penttilä, 1974



Helsinki  
Helsingfors



Green transition  
New technologies  
Transformation of energy production  
Climate impact of construction  
Modern architecture and building heritage  
Prominent landmark  
Developing area  
Cultural and communal potential  
Creativity and pioneering spirit  
"Museum of the future"



# Conducted Surveys and Studies

- 1) Soil, groundwater, and other studies conducted since 1995
- 2) Contamination studies conducted since 2016
- 3) **2015 Building historic assessment, Okulus (Building History Survey, Building Preservation Objectives, New Use Ideation)**
- 4) **2018 Hanasaari B Vision, Koko Architects**
- 5) 2019 Risk assessment of the Hanasaari area, general overview
- 6) 2020 Ideation for the power plant's continued use, the city's working group
- 7) 2020 Withdrawal plan, Ramboll, 30.11.2020
- 8) **2021 Suitability study, H-L Arkkitehdit**
- 9) 2021-22 Structural and facade condition surveys and cost estimate, Ramboll
- 10) 2022 Foundation condition survey of the laboratory building, Ramboll
- 11) **2023 Study on preserving the power plant, Buro Happold**
- 12) 2023 Demolition plan diagram H-L Arkkitehdit
- 13) 2023 General demolition plan, Ramboll
- 14) 2023 Documentation of the power plant's operations, Museum of technology
- 15) 2023 Protection diagrams for the interiors, Okulus

# Anatomy of the Power Plant

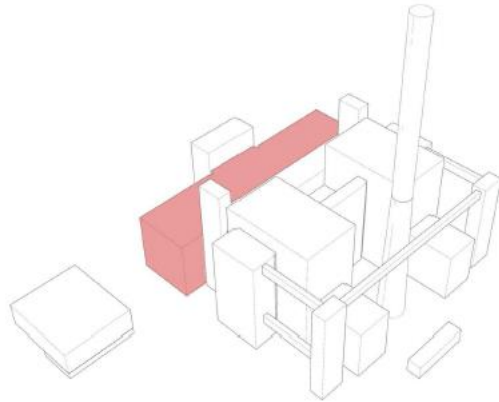

Turbine hall

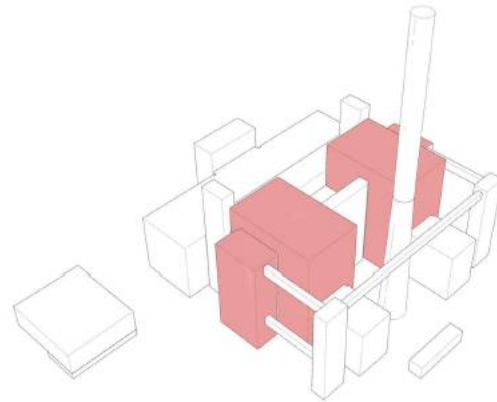

Boiler halls

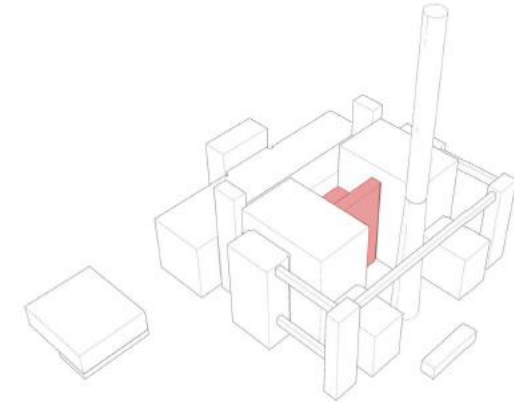

Auxiliary boiler hall

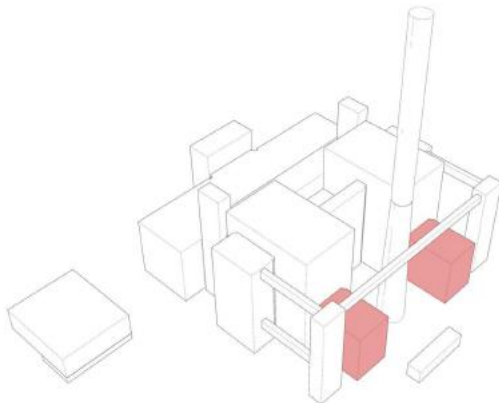

Electrostatic precipitator halls

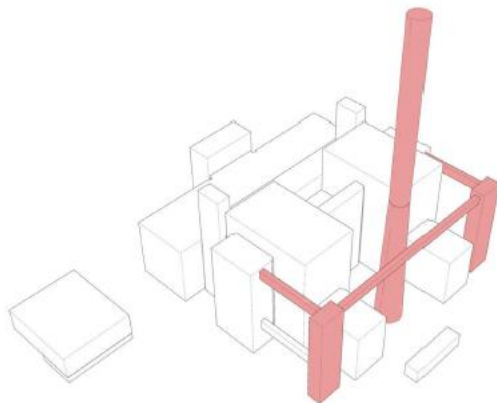

Ash Towers, conveyors, chimney

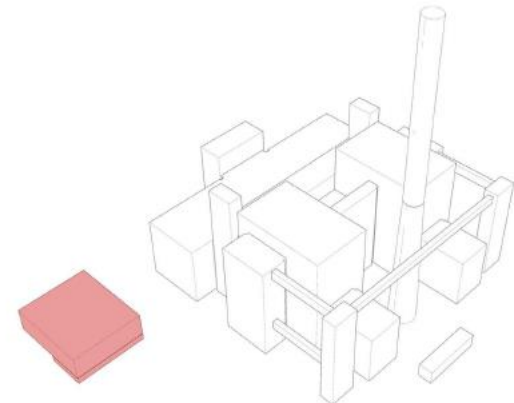

Social/staff building



# About the Potential

- Large, high spaces are flexible and suitable for many different purposes
- New intermediate floors, light wells, and facade openings are possible
- Spaces within a space, new sections, courtyards, and development of outdoor areas are possible
- Roofs have potential for terraces, solar power plants, and green roofs
- The power plant is suitable for uses such as museum and exhibition activities, sports and events, restaurants and offices, as well as commercial purposes

Helsinki

506 000 m<sup>3</sup>  
~37 000 m<sup>2</sup>

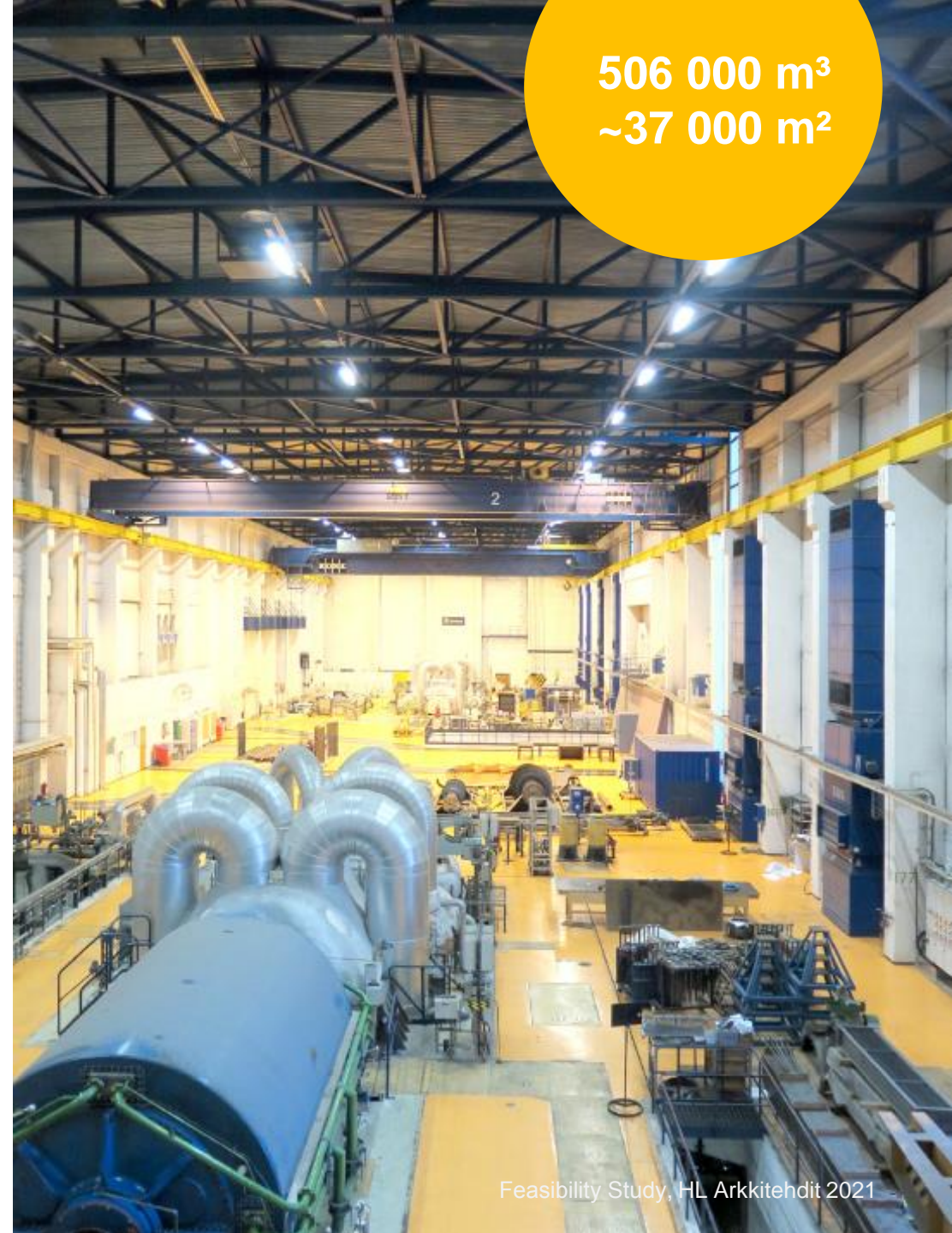



# On Urban Planning

- No existing city plan for the power plant area
- Hanasaari's city plan's participation and assessment plan 2022
- Proposal for changes to Sörnäinen waterfront road, Urban Environment Committee 5/23
- Suvilahti Event Hub's plan approved by Helsinki City Council 4/23
- Energy Quarter's plan approved by Helsinki City Council 8/23

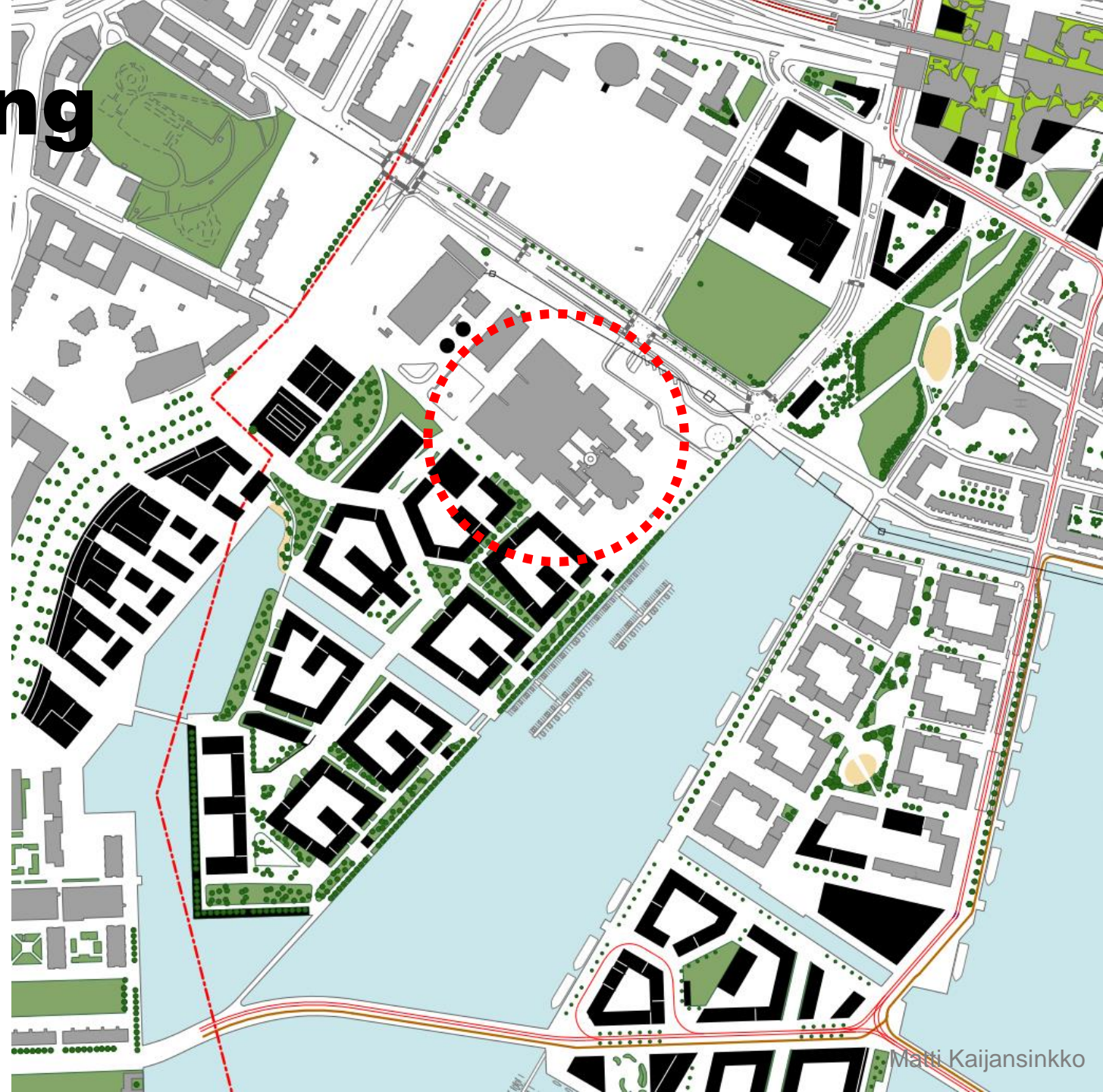



# Subject of Interest (HS 13.9.23)

## International entertainment giant wants an event arena in Helsinki

A company planning an event arena in Hanasaari has partnered with a major international operator.

A new event arena has been fitted between the old power plant building and the shore of Hanasaari. PHOTO: SUVILAHDEN AREENA OY

**Marja Salomaa HS**  
13.9. 10:56

**INTERNATIONAL** event organizer ASM Global and Suvilahden Areena Oy have joined forces in a project planned for Helsinki's Hanasaari.

The privately financed arena project has a prestigious support group proposing the largest arena in the Nordics, a giant 17,000 customer arena to be located on the seaside next to Hanasaari power plant.

Suvilahden Areena Oy has submitted an application for a development reservation to the city. The city has not given an official response, but according to **Timo Nieminen**, CEO of the arena company, the matter has been negotiated at the public servant level.

Helsinki

## Kansainvälinen viihdejätti haluaa Helsinkiin tapahtuma-areenan

Hanasaaren tapahtuma-areenaa puuhaava yritys on saanut yhteistyökumppanikseen suuren luokan kansainvälisen toimijan.



Hanasaaren vanhan voimalarakennuksen ja rannan väliin on soviteltu uutta tapahtuma-areenaa. KUVA: SUVILAHDEN AREENA OY

**Marja Salomaa HS**  
13.9. 10:56

**KANSAINVÄLINEN** tapahtumajärjestäjä ASM Global sekä Suvilahden Areena oy ovat yhdistäneet voimansa Helsingin Hanasaaren suunnitellussa hankkeessa.

Yksityisrahoitteisella areenahankkeella on nimekäs taustajoukko, joka ehdottaa Pohjoismaiden suurinta, 17 000 asiakkaan jättiareenaa Hanasaaren voimalan kylkeen merenrantaan.

Suvilahden Areena oy on jättänyt kaupungille hakemuksen kehittämisvarauksesta. Kaupunki ei ole virallista vastausta antanut, mutta areenayhtiön toimitusjohtajan **Timo Niemisen** mukaan asiasta on neuvoteltu virkamiestasolla.



# Demolition Works in the Area 11/23-6/25





Unspecified small parts of the building in various spaces will be preserved unless decided otherwise based on the plans for the space, as well as surface materials and treatments in general. These include certain elements related to the function of the property (as opposed to the process function) such as electrical networks including end devices and electrical appliances, signs, main lobby artwork, floor carpets and tiling... etc.



# Artifacts to be Preserved



